









LEYENDA SANEAMIENTO DE PLUVIALES

PROYECTADO

-  COLECTOR DE PLUVIALES
-  CUNETETA DE PIE DE TALUD
-  POZO DE REGISTRO DE 1.00 x 1.00
-  REGISTRO CON REJILLA DE 0,60 x 0,60
-  SUMIDERO DE 0,50 x 0,30

EXISTENTE

-  COLECTOR DE PLUVIALES
-  POZO DE REGISTRO
-  REGISTRO CON REJILLA DE 0,60 x 0,60
-  SUMIDERO DE 0,50 x 0,30

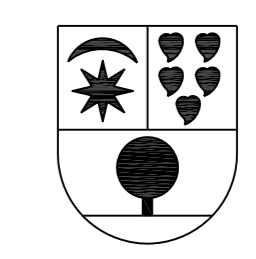
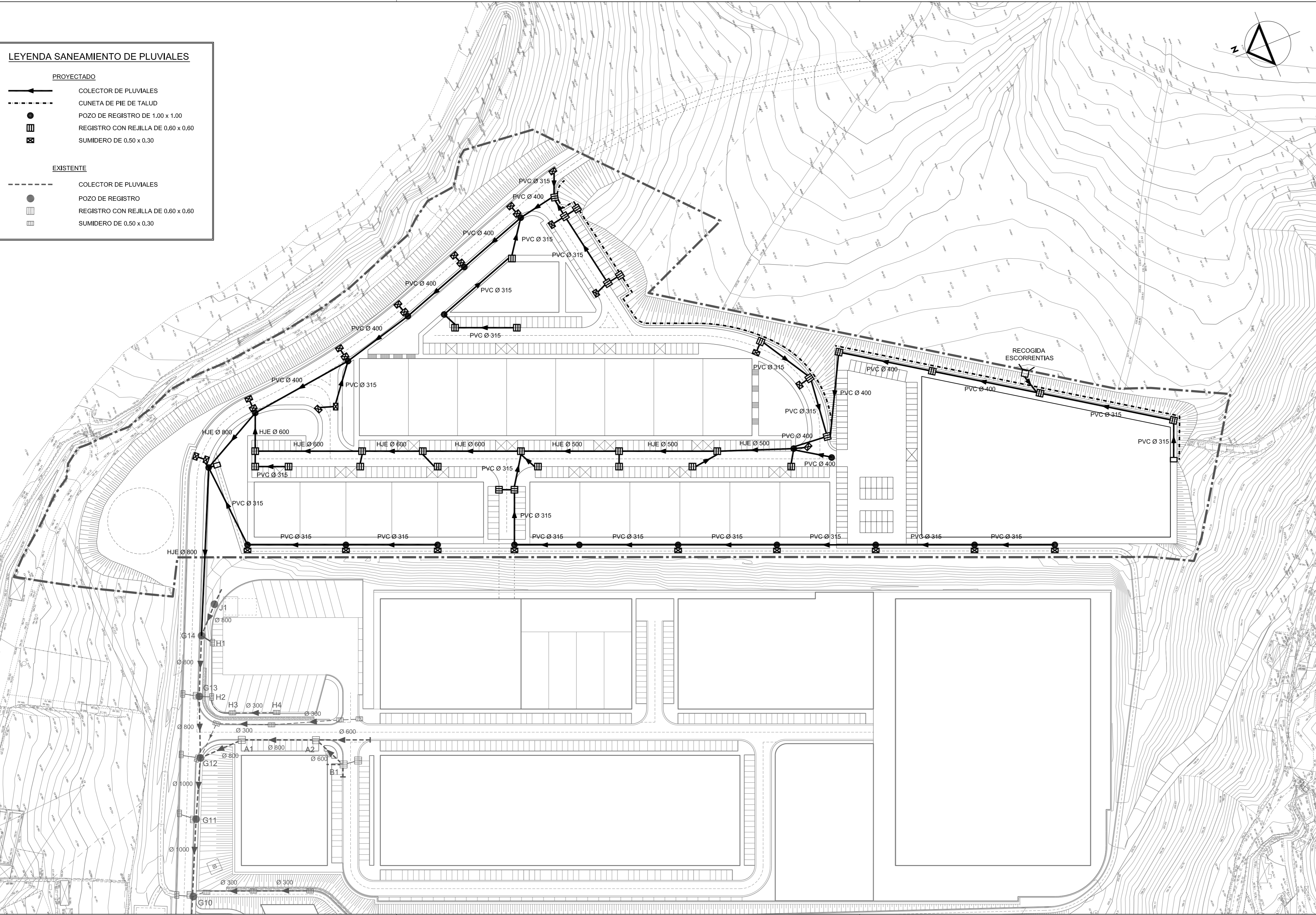
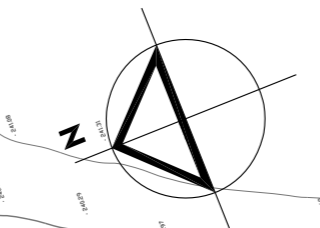

**MODIFICACIÓN DE ELEMENTOS
 DE NORMAS SUBSIDIARIAS
 REFERIDA AL ÁREA 41 "ALTUNE"
 Y NUEVO SECTOR INDUSTRIAL S-48 "HERRIBASO"**

OLABERRIA

REDACTORES:
J. CHÁVARRI SARASUA
 ARQUITECTO

 ESTUDIO DE
 ARQUITECTURA
CHÁVARRI Y ASOCIADOS S.L.P.

P. M. AZKUE
 INGENIERO DE CAMINOS, C. Y. P.

ENDARA
 INGENIEROS ARQUITECTOS S.L.

ORDENACIÓN FORMORIZADA SECTOR 48 "HERRIBASO"
 II. PROYECTO:

**INFRAESTRUCTURAS DE SERVICIOS
 SANEAMIENTO DE PLUVIALES**

FECHA:
 FEBRERO 2010
 ESCALA:
 1/1.000
 PLANO Nº:
 OP-13 II.6.2.1